

# hydroo®

## SDROO SERIES

# S3P

# S3.5P

## 50Hz

Deep-Well  
Submersible  
Pump 3"-3.5"



## PRODUCTS

<b>Presentation</b>	<b>03</b>
<b>3" S3P</b>	<b>04</b>
<b>3.5" S3.5P</b>	<b>07</b>
<b>3" S3P Dimensions</b>	<b>10</b>
<b>3" S3.5P Dimensions</b>	<b>11</b>

## PRESENTATION

**HYDROO has set up a worldwide distribution network with key partners and is providing value to pump engineers and end users. We have an extensive pump portfolio with high-end solutions for many applications, including water-supply booster sets, fire-fighting equipment, borehole, HVAC, drainage and sewage, utilities, irrigation, desalination and RO equipment, and OEM integration, among many others. We provide solutions for all markets for 50 Hz and 60 Hz, including customized versions.**

**HYDROO has a factory in Palol de Revardit (Catalonia- Spain). It's been sized to guarantee our reliable, long-term, personalized manner and offer the best service to all our customers. We provide a wide range of products in an extremely short delivery time, thanks to our Lean manufacturing processes and our qualified professional and enthusiastic team.**

**Our commitment to ethics and legislation in relation to third parties is compiled in a public document of principles. The document has been agreed upon by the entire Hydroo team and its implementation is being coordinated by a committee to ensure the compliance and strengthening of the corporate culture in the whole company.**

**The expansion of Hydroo is based on excellence in operations and a successful business relationship with partners. Therefore, we face a strong growth in the target market. We are fully audited by SGS for ISO9001 and ISO14000 standards annually.**

**At HYDROO, we are committed to providing excellent service to our valued pump partners.**

# S3P 50Hz 3" Submersible Multistage

## Technical Data

### Applications

For water supply from wells or reservoirs.  
For domestic use, for civil and industrial applications.  
For garden use and irrigation.

### Operating conditions

Maximum fluid temperature up to +35 °C.  
Maximum sand content: 0.25 %.  
Maximum immersion: 80 m.  
Minimum well diameter: 3".

### Motor and pump

- Rewindable motor
- Three-phase: 350V - 400V/50Hz
- Single-phase: 180V - 230V/50Hz
- Equipped with start-up control box or digital auto-control box
- Pumps are designed by casing stressed
- NEMA dimension standards
- Performance curve tolerance according to ISO 9906 annex A

### Outlet diameter

1"

### S3P2 - 10

**S3P:** Stainless steel submersible 3" borehole pump, sand resistant type, POM impeller

**2:** Rated flow (m<sup>3</sup>/h)

**10:** Number of impellers

hydroo®

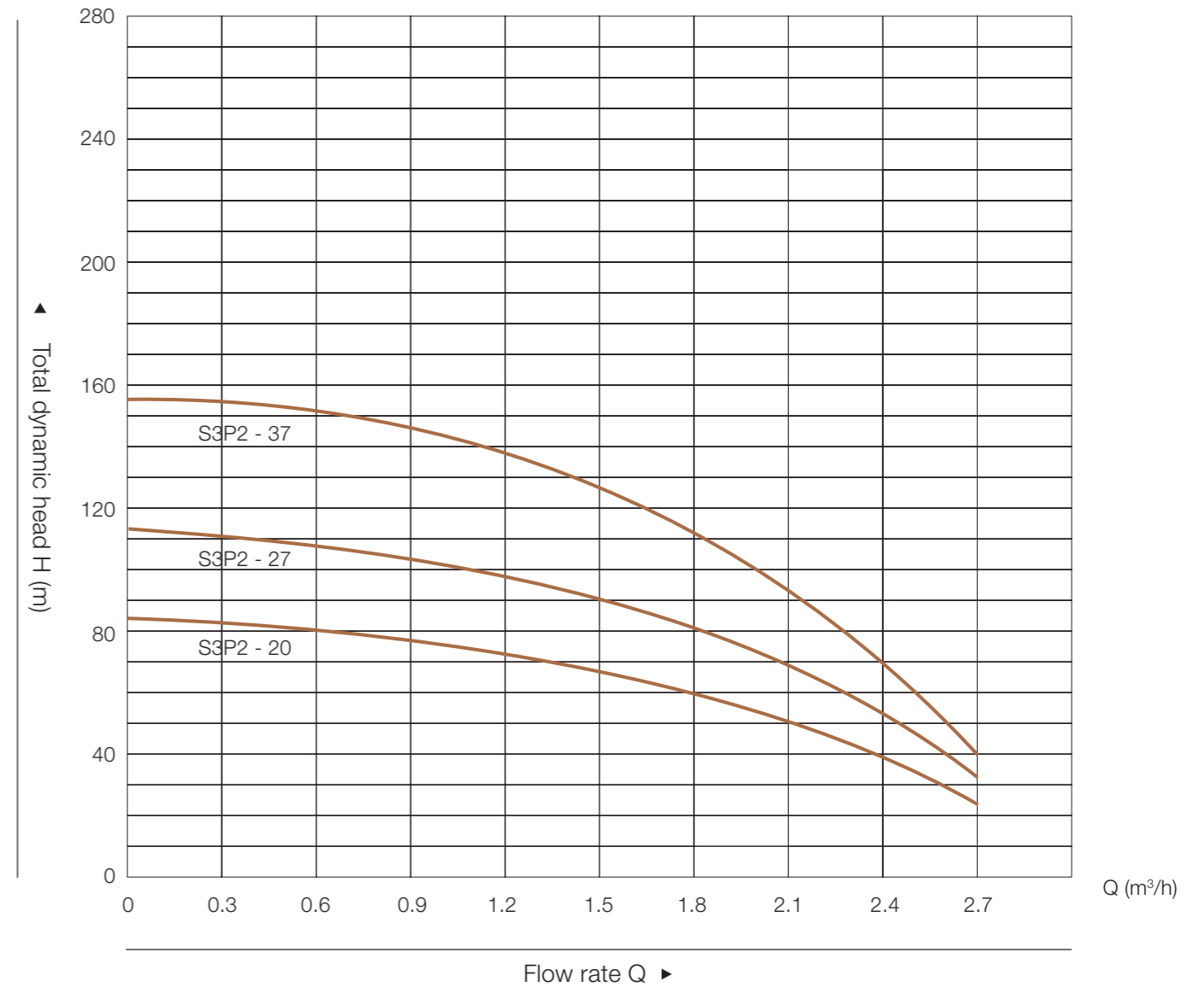

### Performance table

Type	Motor power		Q (m³/h)	Delivery N~2850r/min									
	KW	H		0	0.3	0.6	0.9	1.2	1.5	1.8	2.1	2.4	2.7
S3P2-20	0.55	0.75	H(m)	84	82	78	76	72	66	58	48	36	20
S3P2-27	0.75	1		113	111	105	102	97	89	79	65	48	27
S3P2-37	1.1	1.5		155	152	144	140	133	122	107	89	66	37

Components	Material
Delivery casing	AISI 304 SS
Strainer	AISI 304 SS
Diffuser	Polycarbonate
Impeller	POM
Shaft	AISI 304 SS
Shaft coupling	AISI 304 SS
Wear ring	Rubber NBR
Motor external casing	AISI 304 SS
Mechanical seal	Special seal for deep well (carbor-sic/tc)
Shaft	AISI 304 SS
Bearing	NSK
Seal lubricant oil	Oil for food machinery and pharmaceutical use.

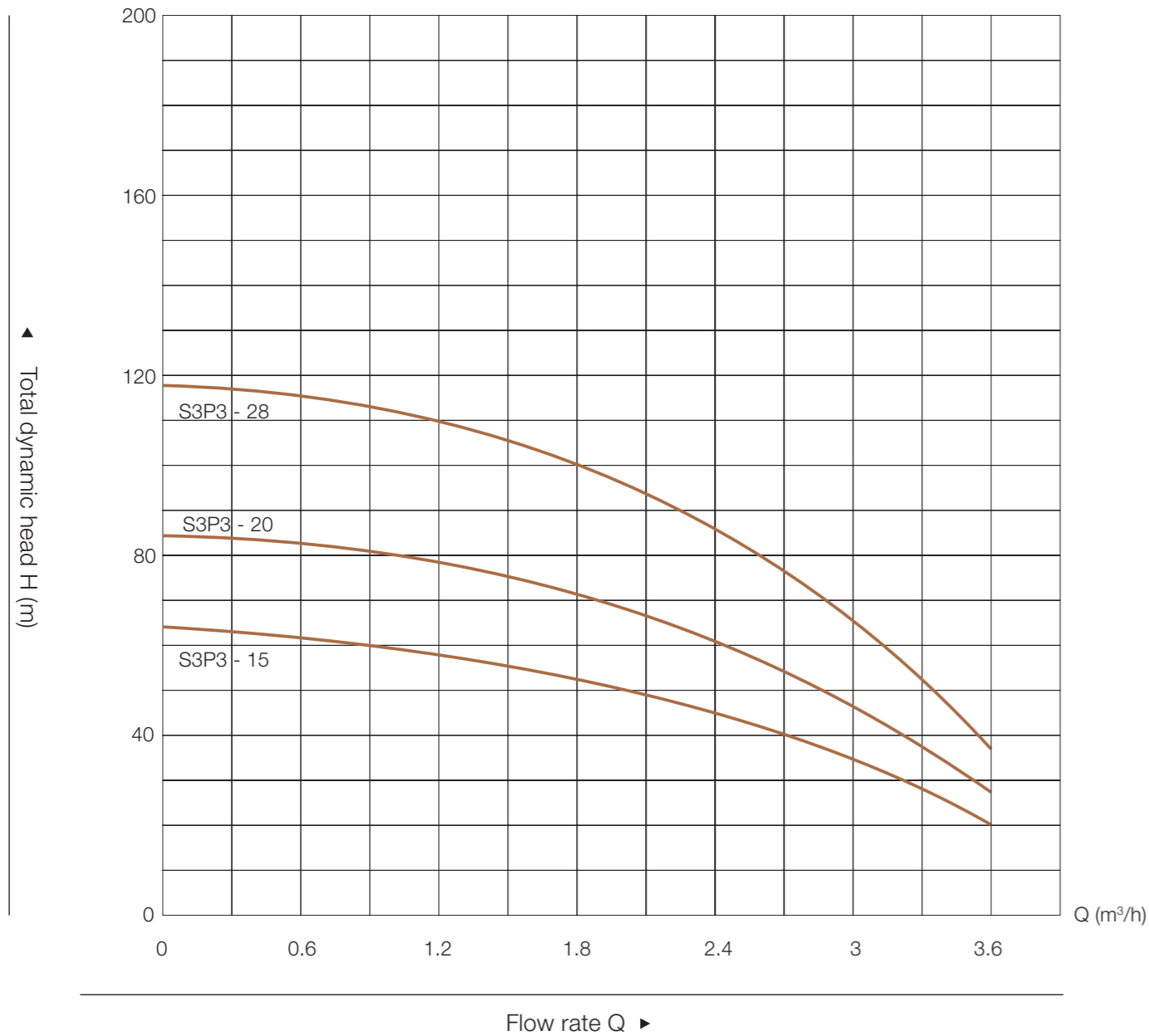

**Performance table**

Type	Motor power		Delivery N≈2850r/min													
	KW	H	Q (m³/h)	0	0.3	0.6	0.9	1.2	1.5	1.8	2.1	2.4	2.7	3	3.3	3.6
Three Phase / Single Phase			H(m)													
S3P3-15	0.55	0.75		63	62	61	60	58	56	53	50	46	41	35	27	20
S3P3-20	0.75	1		84	83	82	80	78	74	71	67	61	54	46	37	27
S3P3-28	1.1	1.5		117	116	114	112	109	104	100	93	86	76	65	51	37

# S3.5P 50Hz 3.5" Submersible Multistage

**Tecnical Data**

**Applications**

For water supply from wells or reservoirs.  
For domestic use, for civil and industrial applications.  
For garden use and irrigation.

**Operating conditions**

Maximum fluid temperature up to +35 °C  
Maximum sand content: 3 %  
Maximum immersion: 120 m.  
Minimum well diameter: 3.5"

**Motor and pump**

- Rewindable motor
- Three-phase: 350 V - 415 V/50 Hz
- Single-phase: 150 V - 240 V/50 Hz
- Equipped with start-up control box

**Outlet diameter**

1 1/4"

**S3.5P2 - 9**

**S3.5P:** Stainless Steel submersible 3,5" borehole pump, sand-resistant type, POM impeller  
**2:** Rated flow (m³/h)  
**9:** Number of impeller

hydroo®



Components	Material
Pump casing	AISI 304 SS / 201 SS
Outlets	Cast-Cu
Inlets	Cast-Cu
Strainer	AISI 304 SS
Diffuser	Polycarbonate
Impeller	POM
Pump shaft	AISI 304 SS / 201 SS
Shaft coupling	AISI 304 SS / 201 SS
Motor casing	AISI 304 SS / 201 SS
Top chock	Cast-Cu / Cast-Iron
Mechanical seal	Graphite-Ceramic / TC
Motor shaft	AISI 304 SS
Bearing	NSK / C&U
Seal lubricant oil	10# White oil

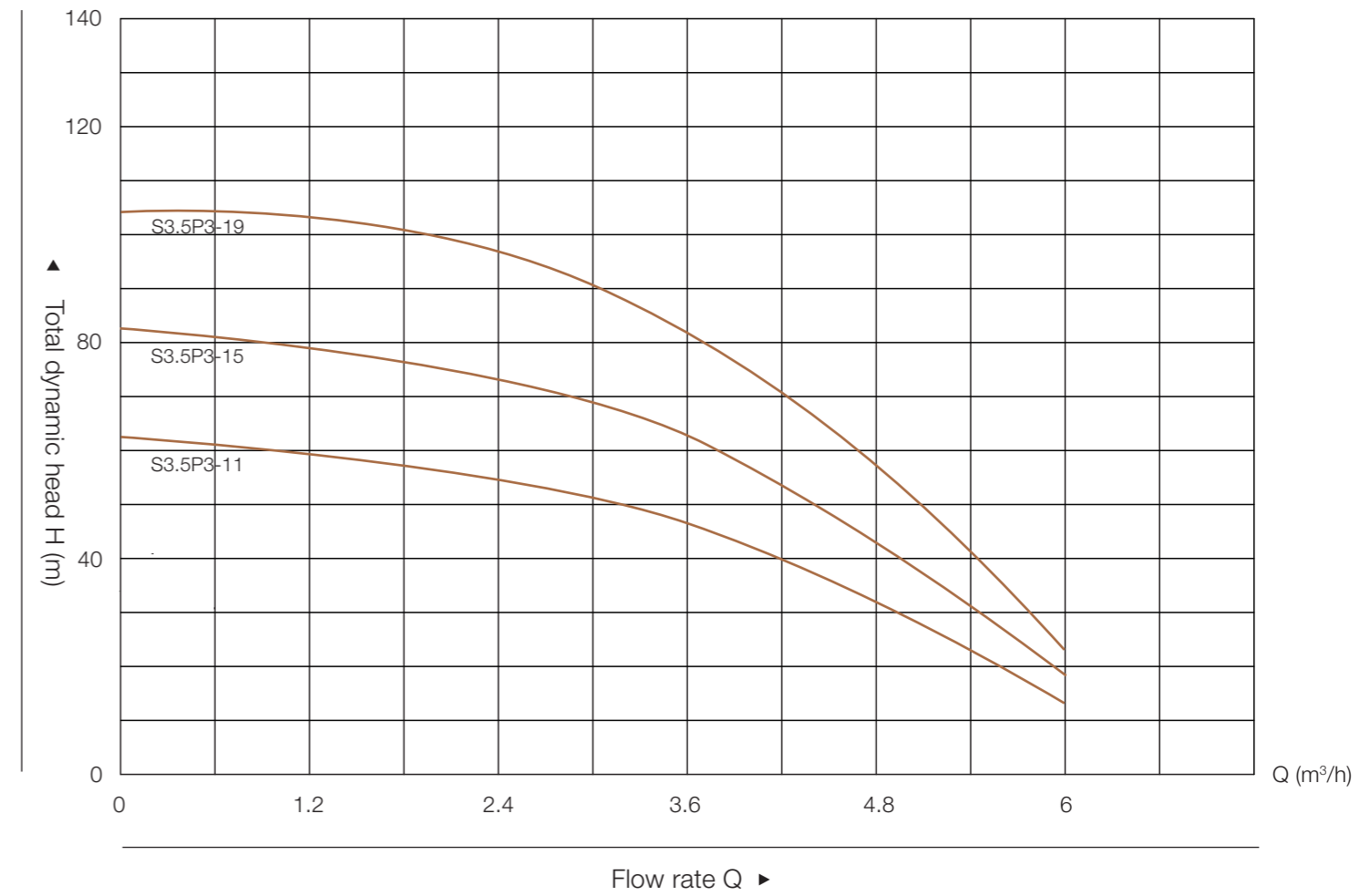
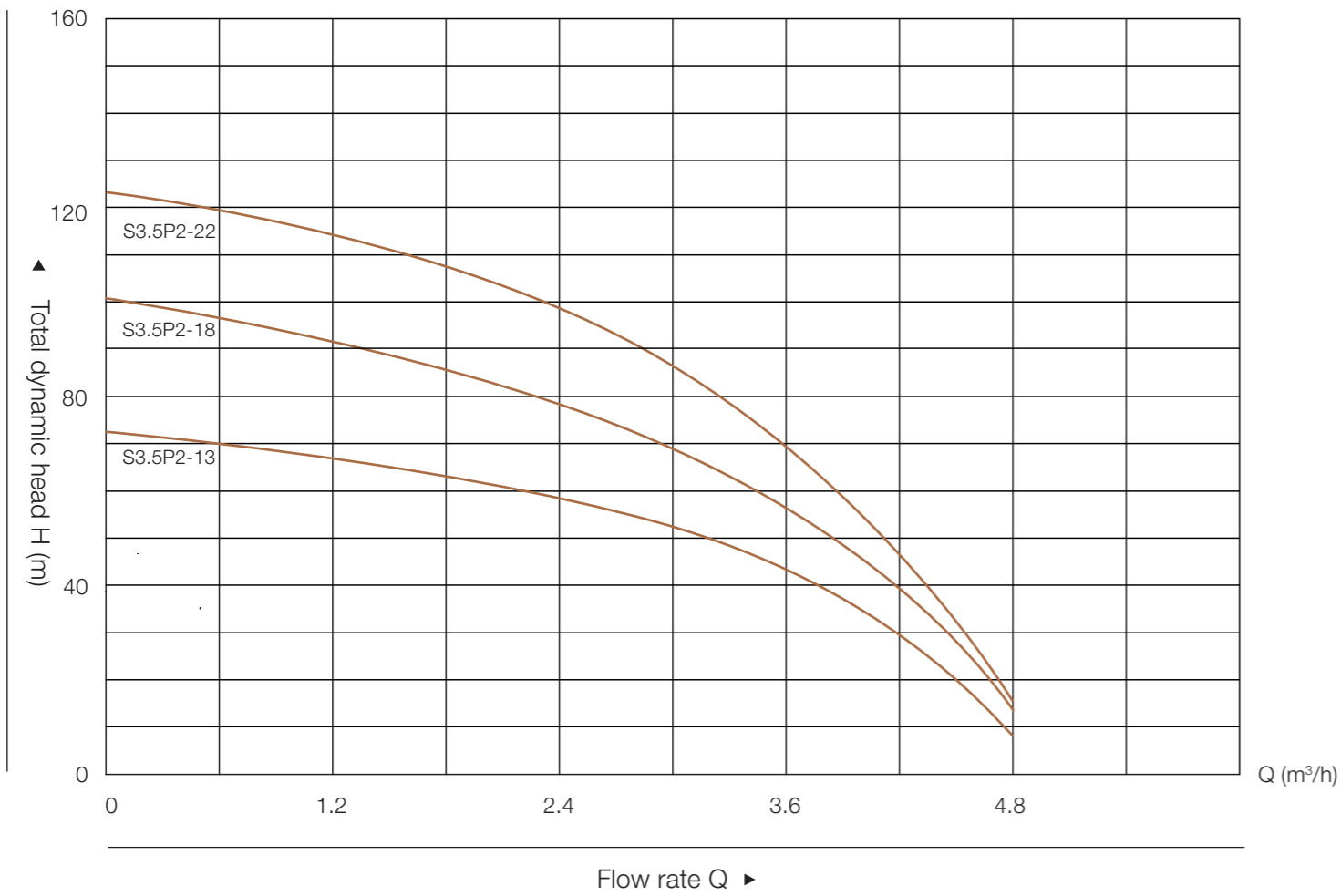

### Performance table

Type	Motor power		Q (m <sup>3</sup> /h) l./min	Delivery N≈2850r/min								
	KW	HP		0	0.6	1.2	1.8	2.4	3.0	3.6	4.2	4.8
Three Phase/ Single Phase				0	10	20	30	40	50	60	70	80
S3.5P2-13	0.55	0.75	H(m)	73	70	66	64	57	52	44	29	9
S3.5P2-18	0.95	1.3		101	97	92	89	79	68	57	40	13
S3.5P2-22	1.1	1.5		123	119	112	109	97	83	70	48	15

### Performance table

Type	Motor power		Q (m <sup>3</sup> /h) l./min	Delivery N≈2850r/min											
	KW	HP		0	0.6	1.2	1.8	2.4	3.0	3.6	4.2	4.8	5.4	6.0	
Three Phase/ Single Phase				0	10	20	30	40	50	60	70	80	90	100	
S3.5P3-11	0.55	0.75	H(m)	62	61	59	58	54	50	45	40	33	22	13	
S3.5P3-15	0.95	1.3		82	81	79	78	74	68	62	55	45	30	18	
S3.5P3-19	1.1	1.5		103	102	100	100	93	87	78	70	57	38	23	

# S3P 50Hz 3"

Installation  
dimension

hydroo®

# S3.5P 50Hz 3,5"

Installation  
dimension

hydroo®

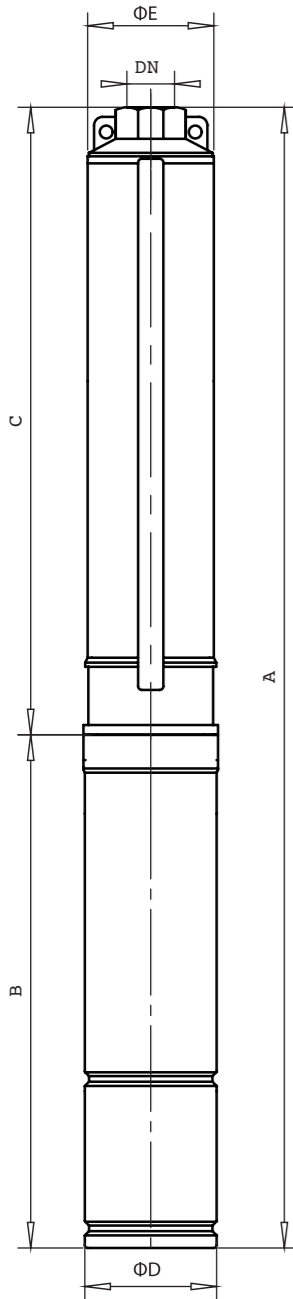

Model	Size (mm)						Weight (kg)	
	A	B	C	DN	ΦE	ΦD	Pump with motor	Controller
S3P2-20	1093	407	686	1"	69	72	10.3	0.75
S3P2-27	1324	458	866	1"	69	72	12.5	0.75
S3P2-37	1636	523	1113	1"	69	72	15.2	0.75

Model	Size (mm)						Weight (kg)	
	A	B	C	DN	ΦE	ΦD	Pump with motor	Controller
S3P3-15	1037	407	630	1"	69	72	10.1	0.75
S3P3-20	1219	458	761	1"	69	72	12.1	0.75
S3P3-28	1516	523	993	1"	69	72	14.7	0.75

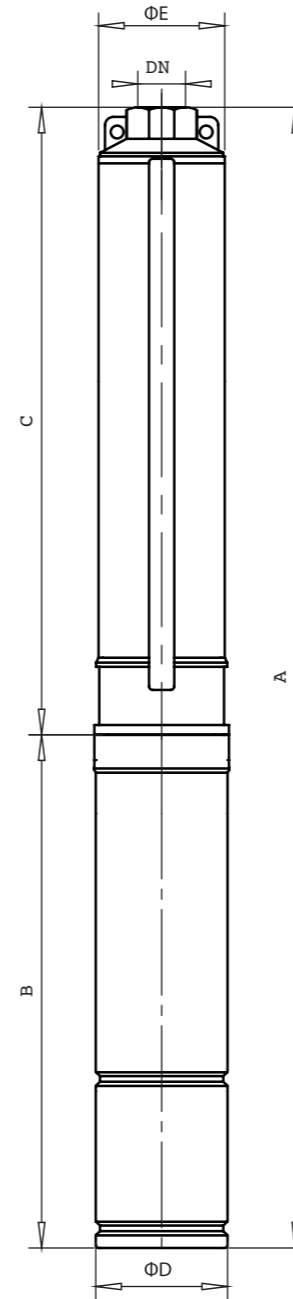

Model	Size (mm)						Weight (kg)	
	A	B	C	DN	ΦE	ΦD	Pump with motor	Controller
S3.5P2-13	1011	400	611	1.5"	90	88	16	0.75
S3.5P2-18	1185	435	750	1.5"	90	88	18	0.75
S3.5P2-22	1382	486	896	1.5"	90	88	24	0.75

Model	Size (mm)						Weight (kg)	
	A	B	C	DN	ΦE	ΦD	Pump with motor	Controller
S3.5P3-11	978	400	578	1.5"	90	88	15	0.75
S3.5P3-15	1179	435	744	1.5"	90	88	17.4	0.75
S3.5P3-19	1361	486	875	1.5"	90	88	19	0.75

# hydroo®

Be pumping partners

**HYDROO Pump Industries SL**  
**Ctra. Girona-Banyoles, km. 10**  
**17843 Palol de Revardit**  
**Catalonia. Spain**  
**Tel. +34 972 394 654**  
**E-mail: [info@hydroo.com](mailto:info@hydroo.com)**  
**[www.hydroo.com](http://www.hydroo.com)**

202228-CTL-SP-EN  
subject to amendments

